

# Line Voltage Passive Infrared Fixture Integrated Outdoor Sensor WEC-3PR-60 Instruction

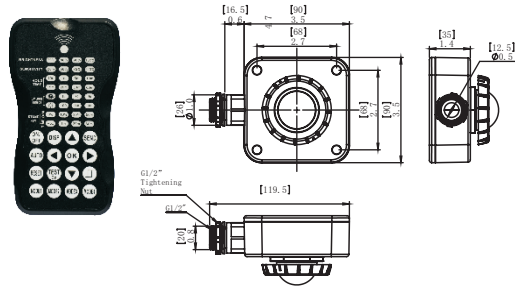

WEC-3PR-60



## Product brief

The product mounts in an outdoor lighting fixture and provides multi-level control based on motion and/or daylight contribution. It controls 0-10 VDC LED drivers or dimming ballasts, as well as non-dimming ballasts and, with an Fresnel Lens, is rated for wet and cold locations. All control parameters are adjustable via a wireless configuration tool capable of storing and transmitting sensor profiles.

## Technical parameters

120/277 VAC, 50/60Hz  
 800W/1200W Max Tungsten, Ballasts, LED driver  
 1/6HP  
 Detect Area: 360°, maximum coverage 60' diameter from 40' height  
 High mode: 0-10 V; default 10 V  
 Low mode: Off, 0-9.8 V; default 1 V  
 Operating temperature: -104-158°F (-40-70°C)  
 Operating Humidity: 20-90%  
 IP65  
 Five year warranty

## Function and options

If sensor in outdoor mode, it is better for outdoor using, so called outdoor mode. The light will on 10-30% automatically if the ambient light level below the lux set point. and the light will off automatically if the ambient light level high than 600Lux, even with presence detected.

## OUTDOOR MODE(AUTO+TEST)



If with insufficient natural light the light automatically dims to 0, 10% 20% 30%.  
 With insufficient ambient light, the sensor switches 100% on the light automatically when person enters the room.  
 People left, light dims to 0/ 10% /20%/30% (options) standby level after the hold time.  
 People left, light still dims to 0/ 10%/20%/30% if with insufficient ambient light.  
 Light will switch off automatically even with presence detected, if the ambient light is sufficient.

# Line Voltage Passive Infrared Fixture Integrated Outdoor Sensor WEC-3PR-60 Instruction

## INDOOR MODE



If with insufficient natural light, the light does not automatically dim to 0, 10% 20% 30%.  
 With insufficient natural light, the sensor switches 100% on the light automatically when person enters the room.  
 People left, light still dims to 0/ 10%/20%/30% if with insufficient natural light.  
 If with insufficient natural light switches off automatically after Semi bright brightness time standby period elapsed.

## Difference

In outdoor mode: the light will on 10-30% automatically when ambient light level below the lux setpoint, even if even with presence is not detected. In indoor mode: the light will not on automatically when ambient light level below the lux setpoint.

## Sensor Mounting

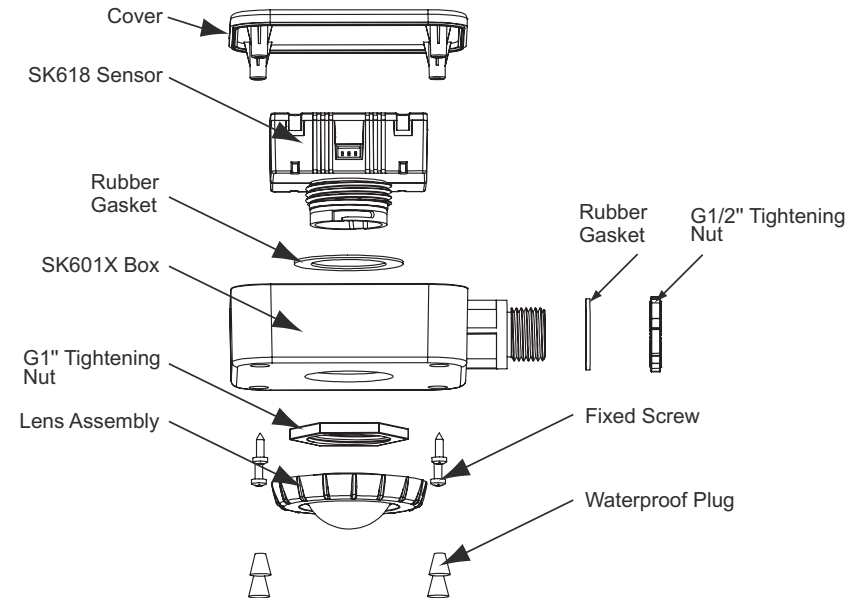

## Coverage Patterns

### LW1

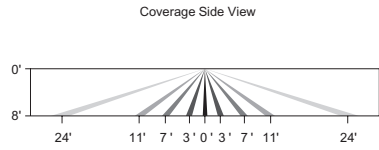

LW1: 360° Coverage

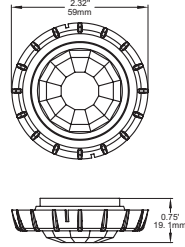
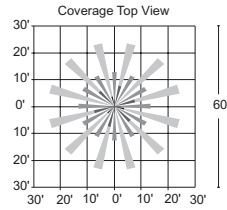

### LS2

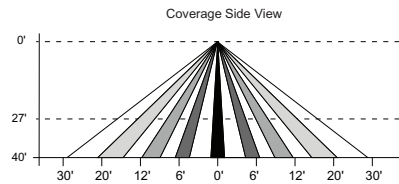

LS2: 360° Coverage

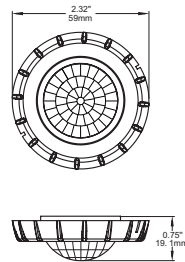
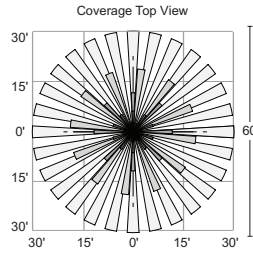

KEY	FUNCTION	KEY	FUNCTION
	Press the on/off button, the light goes to permanent on or permanent off mode, the sensor is locked, MUST Press "AUTO" to quit from this mode.		Press "Auto" button, the sensors starts to work automatically and all parameters remains the same as the latest status in auto mode.
	Display current parameters		The button "Test" is for testing purpose sensitivity only, the sensor goes to test mode (hold time is only 2s) automatically after commissioning, meanwhile the stand-by period and daylight sensor are disabled. Press "AUTO" to quit from this mode.
	upload the selected parameters to sensors		When the light level exceeds this setting, the lights will turn off even when the space is occupied. Once the light level exceeds this setting, the sensor will wait and monitor for 1 mins in order to confirm the light level increase is not temporary before forcing the lights to go off. When light level goes below the settings, the light will turn on even without motion detection after 1min. This feature is disabled by default, if want to open this setting, just press @, choose daylight sensor setpoint on/off.
	Enter in the setting condition and navigate to UP and Down		
	Navigate to Right and Left		
	Confirm selected parameters and saving		
	Default settings:		Four modes with existing parameters which are available to be updated and saved in Modes
BRIGHTNESS	Adjust the light brightness during hold time.		Select  threshold for sensor to turn light fixture ON. Select  current surrounding lux value as daylight lux threshold, select  the built-in daylight sensor stops working, and all motions detected could turn the light fixture on, no matter how bright the natural light is.
SENSITIVITY	Adjust sensor sensitivity		
HOLD TIME	The time of light fixture remains at programmed 70%/80%/100% level after motion is not detected		Select the stand-by dimming level at 0%/10%/30%/50%; Note: "∞" means bi-level dimming control, fixture never switches off.
STAND-BY TIME	Select stand-by period at 1min/30min / 60min/∞		



## Wiring Diagrams

wiring with dimming ballast or LED driver.

Dimming Driver

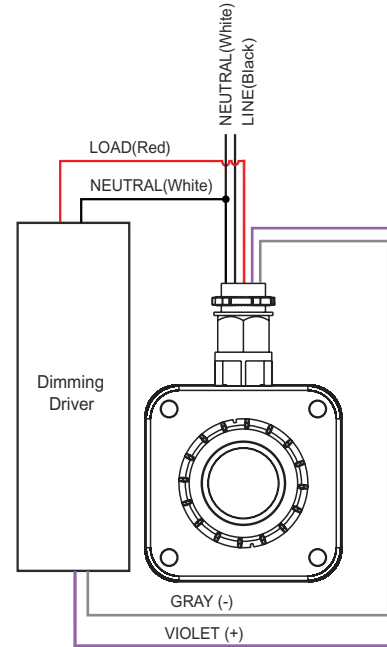

wiring with non-dimming ballast or LED driver.

Non-Dimming Driver

